

Door straightener kit 2240mm

- Prevents bending and warping of large door panels.
- One door straightener is recommended for doors up to 750mm. For wider doors use 2 straightening bars per door.
- Easy centre adjustment with a spanner.
- Easily fitted.
- 3x standard 35mm hinge holes linked with 10mm grooves is the only machining required.

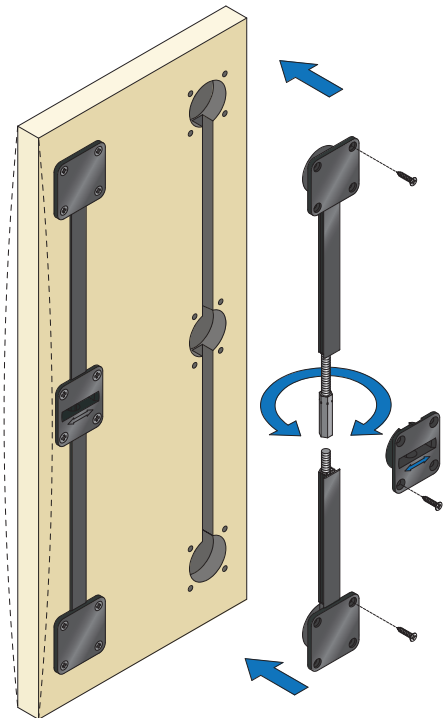

Door straightener adjustment

If the door is in the ❶ position, turn the hexagon nut in the ❸ direction in order to straighten the door; vice versa, turn the hexagon nut in the opposite ❹ direction to restore the verticality of the door from position ❷.

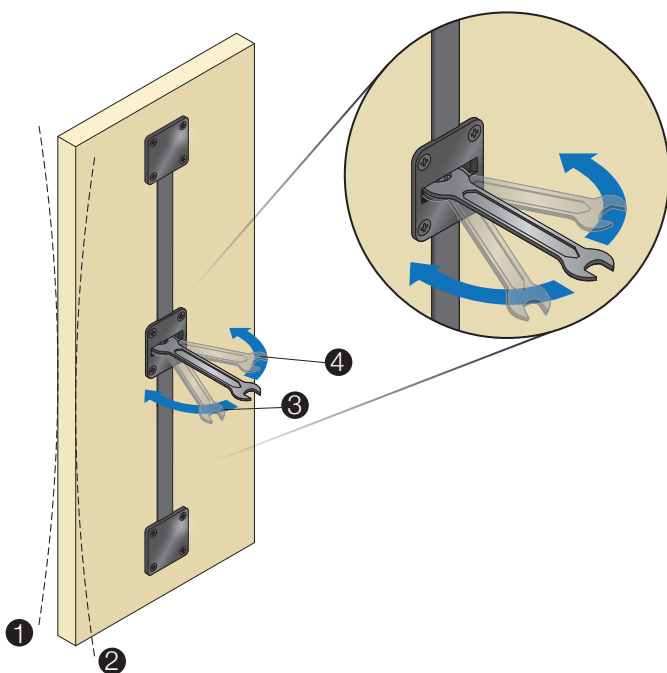

Drilling dimensions

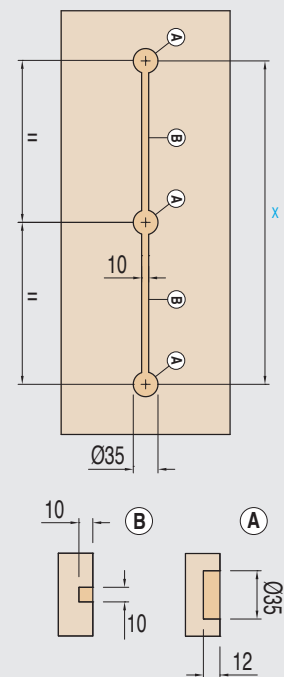

X = 2240mm outer bore centre distance for shorter doors simply cut threaded rods.