

Kit Contents

- Single colour dimming Zigbee remote

Important Safety Information

DISCLAIMER: PLEASE NOTE INSTALLATION SHOULD BE CARRIED OUT BY A QUALIFIED ELECTRICIAN!

- This Zigbee Dim remote is a wireless transmitter that communicates with a variety of Zigbee compatible systems. This transmitter sends wireless radio signals that are used to remotely control a compatible system.
- This Zigbee remote supports 4 groups for binding max. 30 lighting devices and enables to control single colour Zigbee lighting devices.
- This device contains AAA batteries that shall be stored and disposed properly.
- DO NOT expose the device to moisture.

Function Introduction

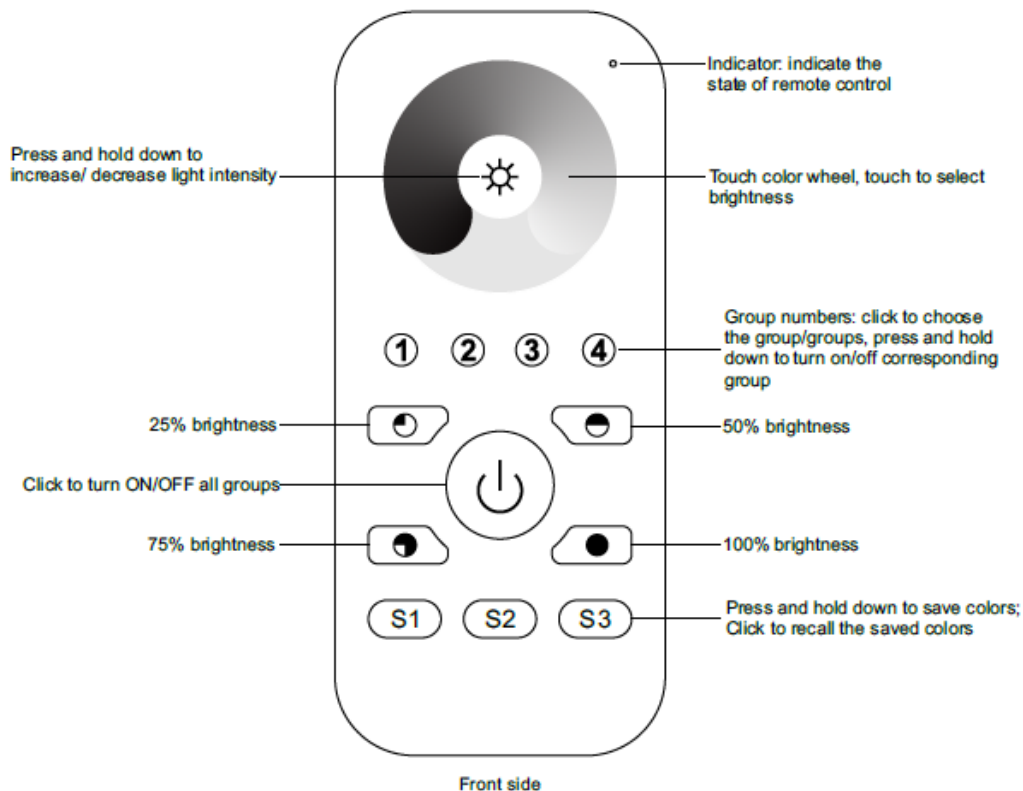

Product Name: Remote Single Single LED Dimming Zigbee Remote

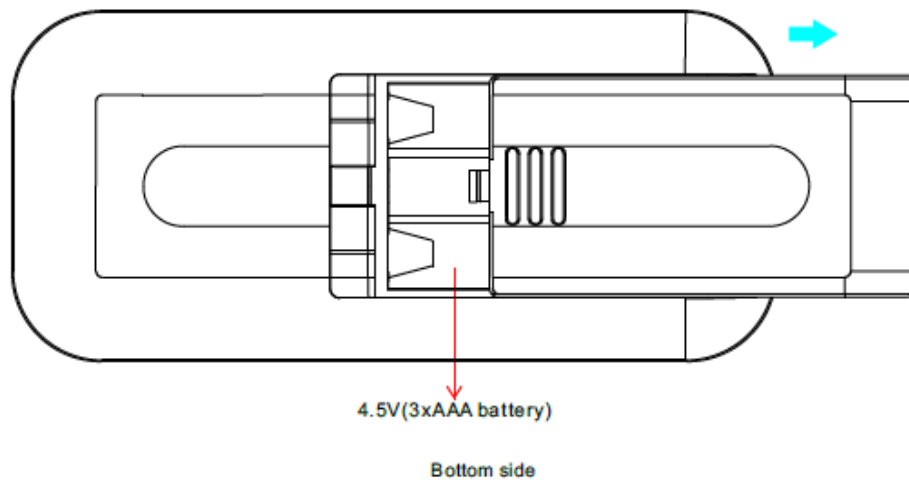

Installation

Zigbee Network Pairing through Coordinator or Hub (Added to a Zigbee Network)

Step 1: Remove the remote from previous zigbee network if it has already been added to it, otherwise pairing will fail. Please refer to the part "Factory Reset Manually".

Step 4: Immediately short press to search nearby network, indicator flashes every 1 second, 20 seconds timeout if there is no network. Indicator will then blink 5 times quickly for successful pairing.

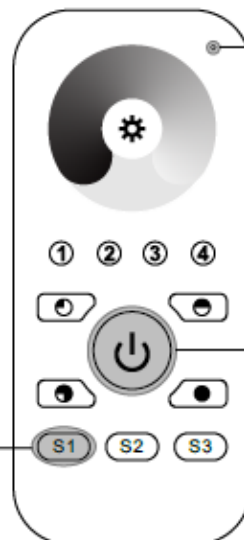

LED indicator

Step 2: From your zigbee controller or hub interface, choose to add device or accessory and enter Pairing mode as instructed by the controller.

Step 3: Press and hold down until LED indicator turns on.

Note: 1) After pairing successfully, the remote information will appear on the controller or hub interface.
2) No remote information will appear on the hub interface if pairing to Philips Hue Bridge.

Removed from a Zigbee Network through Coordinator or Hub Interface

- 1 From your ZigBee controller or hub interface, choose to delete or reset the remote as instructed, indicator flashes 3 times quickly to indicate successful removing.

Factory Reset Manually

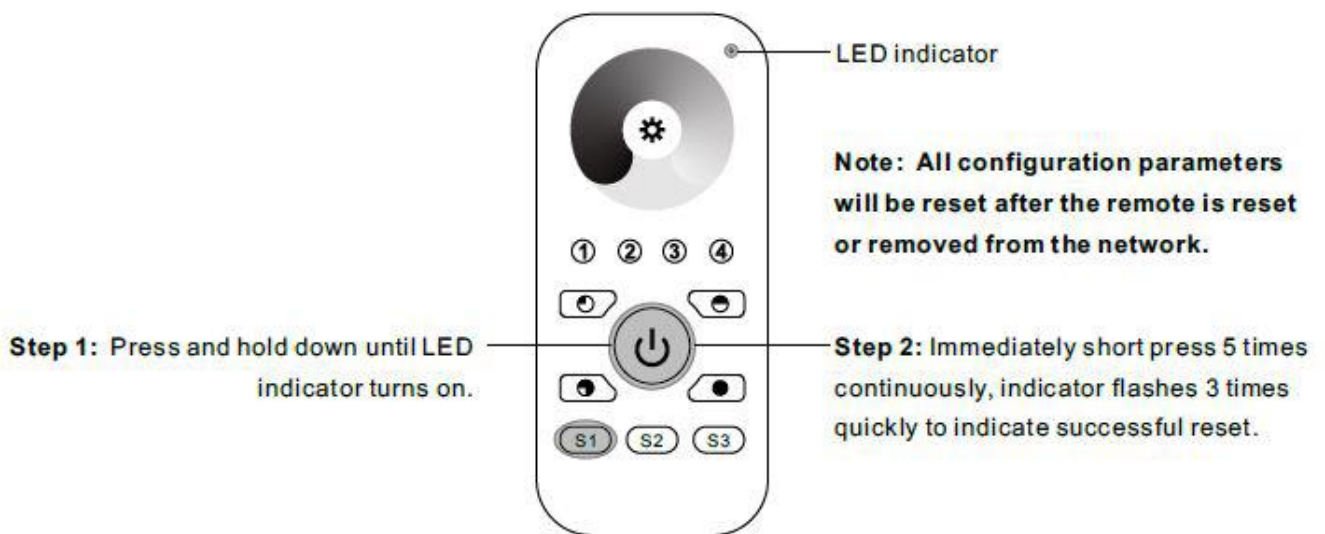

TouchLink to a Zigbee Lighting Device

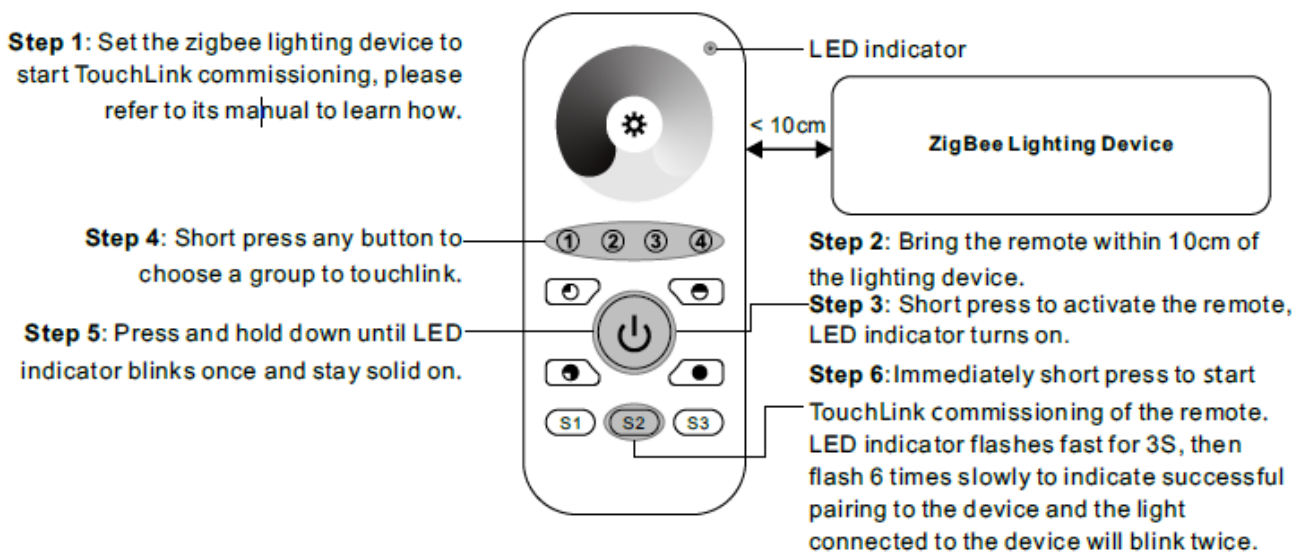

Product Name: Remote Single Single LED Dimming Zigbee Remote



Installation Manual

- Note:** 1) Directly TouchLink (both not added to a ZigBee network), each remote can link with 30 devices.
2) TouchLink after both added to a ZigBee network, each remote can link with max. 30 devices.
3) For Hue Bridge & Amazon Echo Plus, add remote and device to network first then TouchLink.
4) After TouchLink, the remote can control the linked lighting devices.

Remove a Touchlink Paired ZigBee Lighting Device

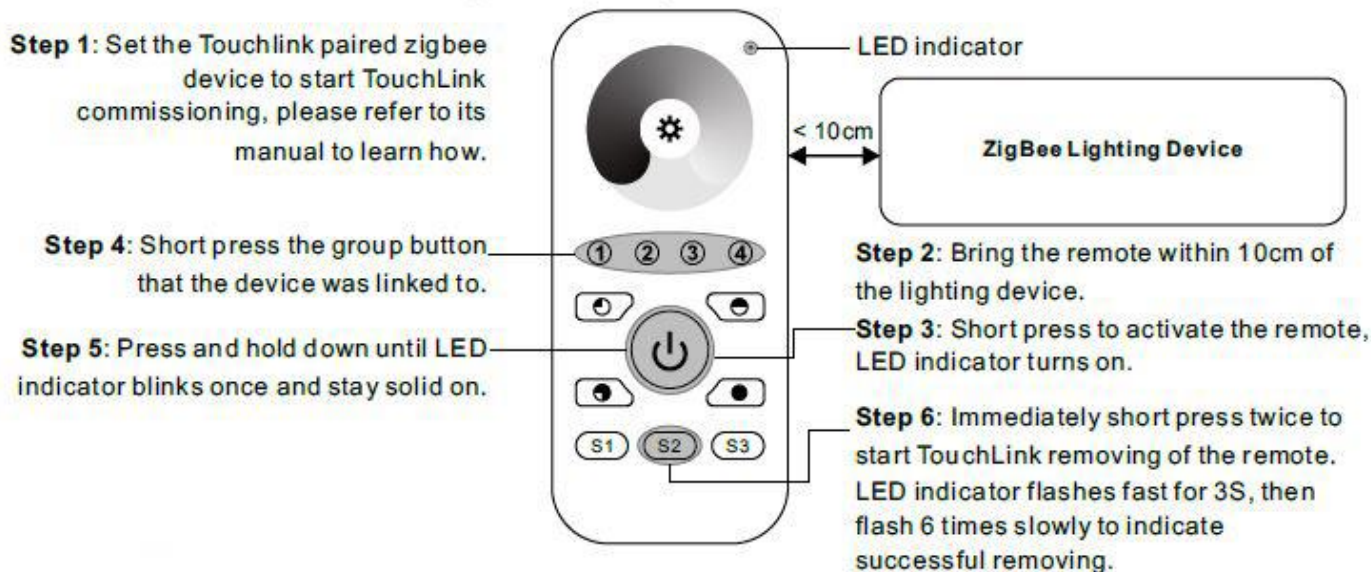

Factory Reset a Lighting Device (Touch Reset)

Note: the device shall be added to a network, the remote added to the same one or not added to any network.

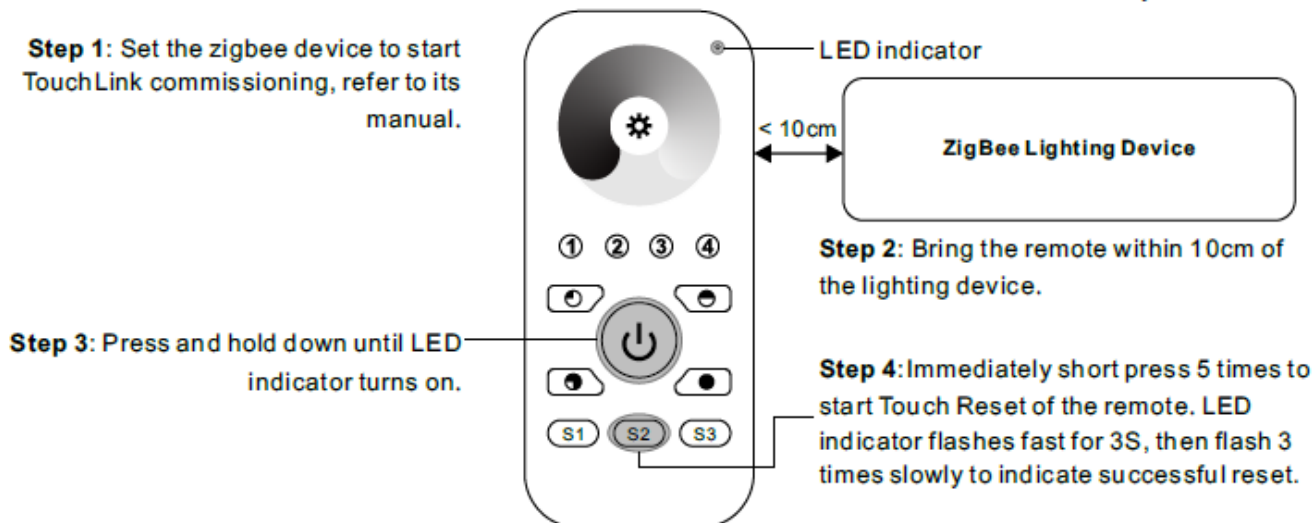

Find and Bind a Zigbee Lighting Device

Note: Make sure the device and remote already added to the same zigbee network.

Step 1: Start find and bind mode on the Zigbee lighting device (initiator node) and enable it to find and bind target, refer to its manual.

Step 3: Short press a group button that you would like to bind the device to.

Step 4: Press and hold down until LED indicator blinks once and stay solid on.

Note: Each remote can bind max. 30 lighting devices.

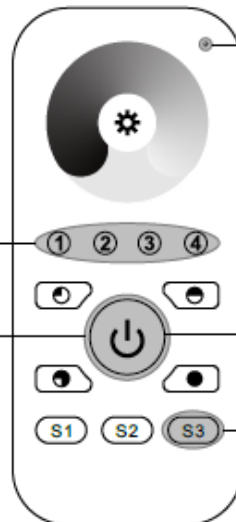

LED indicator

ZigBee Lighting Device

Step 2: Short press to activate the remote, LED indicator turns on.

Step 5: Short press to enable the remote (target node) to find and bind initiator. LED indicator flashes 4 times for successful binding or twice if binding fails.

Find and Unbind a Zigbee Lighting Device

Step 1: Start find and bind mode on the ZigBee lighting device (initiator node) and enable it to find and unbind target, refer to its manual.

Step 3: Short press the group button that the device already bound to.

Step 4: Press and hold down until LED indicator blinks once and stay solid on.

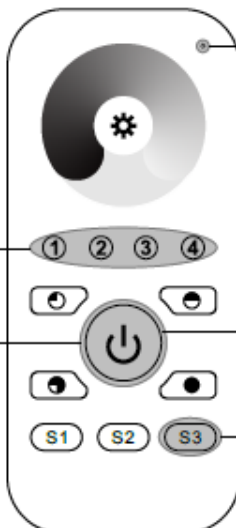

LED indicator

ZigBee Lighting Device

Step 2: Short press to activate the remote, LED indicator turns on.

Step 5: Short press twice to enable the remote (target node) to find and unbind initiator. LED indicator flashes 4 times for successful unbinding or twice if unbinding fails.

Clear All Find and Bind Mode Paired Lighting Devices of a Group

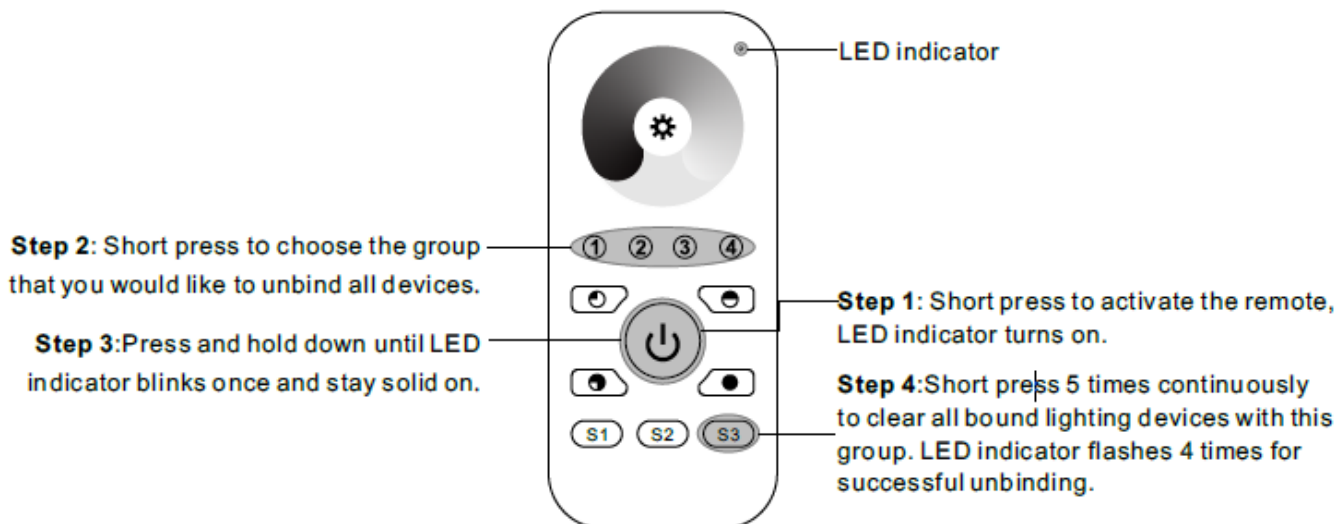

Setup a Network & Add Devices to the Network (No Coordinator or Hub Required)

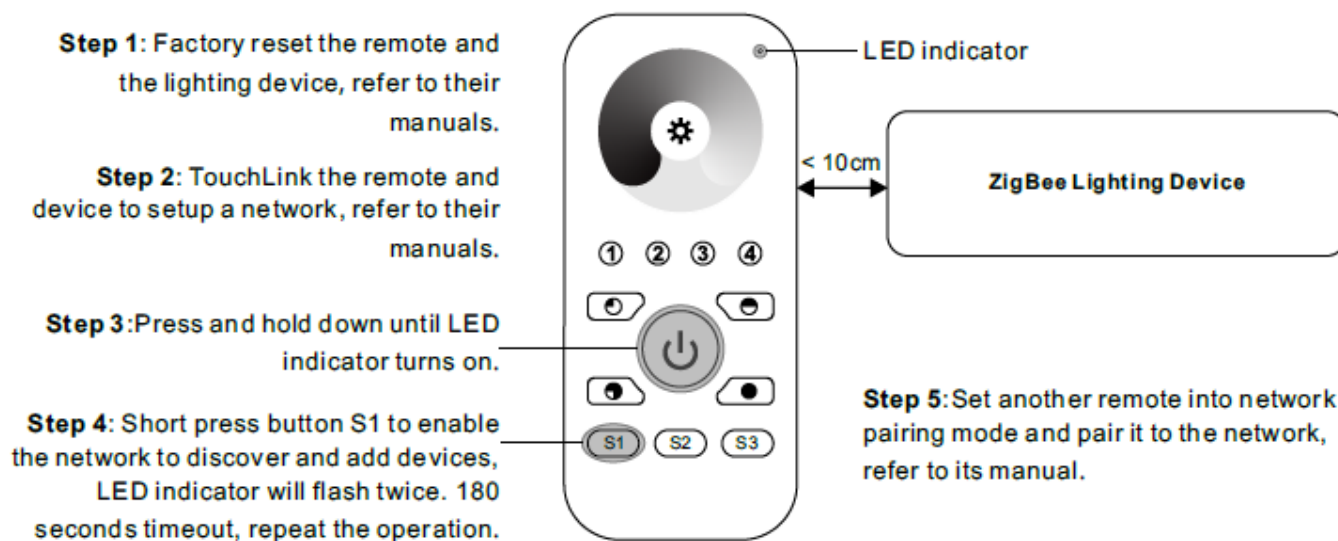

Step 6: Add more remotes to the network as you would like.

Step 7: Factory reset the lighting devices that you would like then add them to the network, refer to their manuals.

Step 8: Touchlink to pair the added remotes and lighting devices, refer to their manuals. Each remote can link with max. 30 lighting devices. Each lighting device can be linked by max. 30 remotes.



How to Check Whether the Remote Belongs to a Network or not

- 1 Activate the remote by clicking All On/Off button (indicator on), then short press any other buttons except group buttons, indicator blinking 3 times means the remote does not belong to any network, blinking once or twice means it has already been added to a network.

Battery Power Monitor Function

The remote will report battery power value to the coordinator under following situations:

- When powered on.
- When short pressing both S2 and S3 buttons simultaneously.
- When operating the switch to send data packets (over 4 hours since last operation).
- When added to the network by a coordinator.

Other Information

Specifications:

- Zigbee Dim remote based on ZigBee 3.0
- Enables to control single colour lighting devices
- High sensitive & high stable touch colour wheel, fast & precise colour control
- Battery powered remote with low power consumption
- Enables to pair Zigbee lighting devices through touchlink commissioning
- Supports find and bind mode to pair with ZigBee lighting devices
- Supports 4 groups for binding max. 30 lighting devices
- 2.4 GHz global operation
- Transmission range up to 30m
- Compatible with universal ZigBee Gateway products
- Compatible with universal single colour Zigbee lighting devices

ZigBee Clusters Supported by This Remote Are As Follows:

Input clusters:

- Basic • Power Configuration • Identify • Diagnostics

Output clusters:

- Identify • Group • Scene • On/off • Level control • OTA

OTA

The remote supports firmware updating through OTA, and will acquire new firmware from zigbee controller or hub every 10 minutes automatically.

Product Name: Remote Single Single LED Dimming Zigbee Remote



Installation Manual

Product Data

Protocol	ZigBee 3.0
Operation Voltage	4.5V(3xAAA battery)
Transmission Frequency	2.4GHz
Transmission Range (free field)	30m
Protection Type	IP20
Dimming Range	0.1%-100%
Dimension	120x55x17mm
Protection Grade	IP20

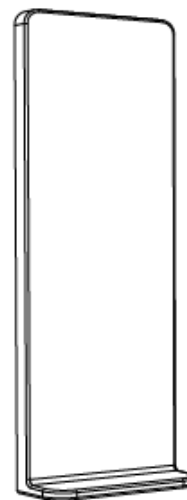

Magnetic Bracket